

# Koganei International House (Construction 1996)

【Address】 2-24-16, Naka-cho, Koganei-shi, Tokyo 184-0012 Japan

【Access】 8minute walk from south exit of JR Higashi-Koganei Station

## 【Type of Room】

Status of the Resident	Type	Quantity	Area(m <sup>2</sup> )
Foreign Student	Single Room 【A】	32	13.50
	Single Room 【B】	12	17.40~18.20
	Couple Room	3	36.50
	Family Room	2	56.90
Foreign Researcher	Single Room	18	17.40~18.20
	Couple Room	1	38.60
Tutor	Couple Room	1	36.50

## 【Individual Room Fixtures】

Each room is furnished with a desk, chair, bookshelf, bed, chest of drawers, refrigerator, dining table, dining chair, unit bathtub, sink, cooking stove, wall cupboard, air conditioner, shoe cupboard, curtains, washing machine, etc.

※Foreign Student Single Room 【A】 is do NOT have a washing machine nor bathroom.

Foreign Student Single Room 【B】 and Foreign Researcher Single Room is do NOT a washing machine.

Please use the communal washing machines in the Laundry Rooms and shared shower rooms.

【Internet】 All rooms are equipped with internet.

【Plan of the house】 ※Room plan for Fuchu International House.

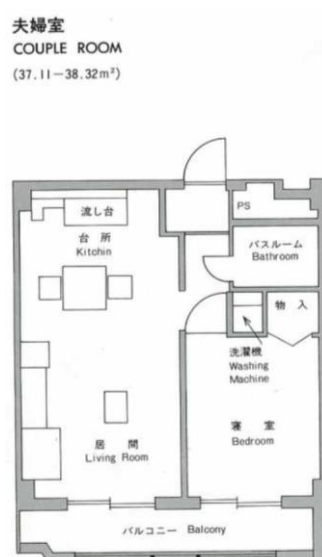

※No individual bathrooms available in the Foreign Students' Single room